



Product Information

Baja Web > Product Information > Parts Lists > GOKART > DN150 Howhit Dune 150cc Go-Kart (VIN PREFIX HT8H)

DN150 Howhit Dune 150cc Go-Kart (VIN PREFIX HT8H)

DN150 Howhit Dune 150cc Go-Kart (VIN PREFIX HT8H)



Brushguard [Image]

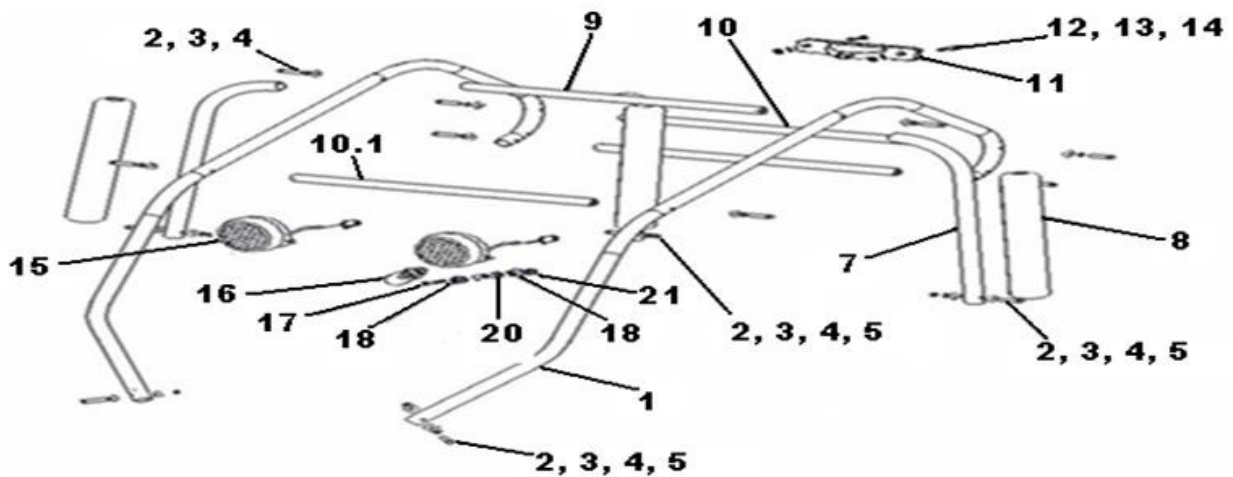

Brushguard

Item No	Part Number	Description	Baja Description	Qty
	DN150-407	BRACKET, HEADLIGHT W/O HARDWARE		2
	DN150-615	BRUSHGUARD PLASTIC END (LARGE)		6
	DN150-616	BRUSHGUARD PLASTIC ENDS (SMALL)		4
	DN150-630	WIRING FOR HEADLIGHTS		1
	DN150-249	BULB, TAILLIGHT		1
001-1	DN150-10	GUARD SIDE RAIL LH (BLUE)		1
001-1	DN150-600	GUARD SIDE RAIL LH (BLACK)		1
001-1	DN150-609	GUARD SIDE RAIL LH (RED)		1
001-2	DN150-11	GUARD SIDE RAIL RH (BLUE)		1
001-2	DN150-601	GUARD SIDE RAIL RH (BLACK)		1
001-2	DN150-610	GUARD SIDE RAIL RH (RED)		1
002	DN150-12	BOLT 8-1.25X60, HEX (PT)		13
003	DN150-13	WASHER M8X14X2, SPRING		13
004	DN150-14	WASHER SPHERICAL M8-32	WASHER SPHERICAL, M8X32	16
005	DN150-15	NUT M8-1.25X9, FLANGE SELF LOCK	NUT M8-1.25X9, FLANGE SELF LOCK	5
006	DN150-16	WASHER M8X16X3X6, SPHERICAL		2
007-1	DN150-17	GUARD VERTICAL RAIL LH (BLUE)		1
007-1	DN150-602	GUARD VERTICAL RAIL LH (BLACK)		1
007-1	DN150-611	GUARD VERTICAL RAIL LH (RED)		1
007-2	DN150-18	GUARD VERTICAL RAIL LH (BLUE)		1
007-2	DN150-603	GUARD VERTICAL RAIL RH (BLACK)		1
007-2	DN150-612	GUARD VERTICAL RAIL RH (RED)		1
008	DN150-19	PADDING, FOAM, 3 LONG 2 SHORT		5
008	DN150-628	WRAPS FOR PADDING, 3 LONG 2 SHORT (NEW)	WRAPS FOR PADDING, 3 LONG 2 SHORT (NEW)	5
008	DN150-037	WRAPS FOR PADDING, 3 LONG 2 SHORT (OLD)	WRAPS FOR PADDING, 3 LONG 2 SHORT (OLD)	5
009	DN150-20	FRAME CROSS MEMBER (BLUE)		3
009	DN150-604	FRAME CROSS MEMBER (BLACK)		3
009	DN150-613	FRAME CROSS MEMBER (RED)		3
010	DN150-21	FRAME BRAKE LIGHT MNT TUBE (BLUE)		1
010	DN150-605	FRAME BRAKE LIGHT MNT TUBE (BLACK)		1
010	DN150-614	FRAME BRAKE LIGHT MOUNTING TUBE (RED)		1
010-1	DN150-619	BRUSHGUARD CROSS TUBE (BLUE)		2
010-1	DN150-617	BRUSHGUARD CROSS TUBE (RED)		2
010-1	DN150-618	BRUSHGUARD CROSS TUBE (BLACK)		2
011	DN150-22	BRAKE LIGHT		1
012	DN150-23	SCREW M4X25		2
013	DN150-24	WASHER LOCK M4		2
014	DN150-25	NUT M4		2
015	DN150-26	HEADLIGHTS, RIGHT AND LEFT	2 HEADLIGHTS SHIPPED PER ORDER	2
016	DN150-27	HEADLIGHT BULB		2
017	DN150-28	BOLT M6-1.0X30, FLANGE (FT)		4
018	DN150-29	HEADLIGHT RUBBER BUSHING		4
021	DN150-32	NUT M8-1.25X9, FLANGE SELF LOCK		4

Frame [Image]

≡

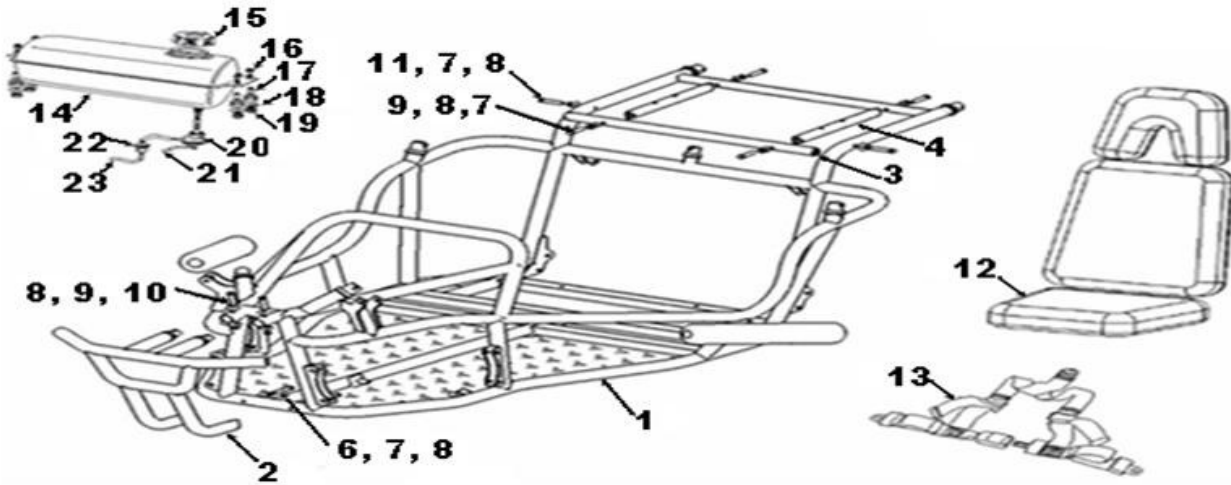
**Frame**

Item No	Part Number	Description	Baja Description	Qty
	DN150-403	SEAT, HEAD REST		1
	DN150-627	BUMPER FRONT PLASTIC END CAPS		2
	DN150-418	SPHERICAL WASHER	SPHERICAL WASHER GAS TANK BOLT	4
001	DN150-33	MAIN FRAME BLUE		1
001	DN150-415	MAIN FRAME RED		1
002	DN150-34	FRONT BRUSHGUARD BLUE		1
002	DN150-416	FRONT BRUSHGUARD RED		1
003	DN150-35	FRAME CROSS MEMBER BLUE	AVAILABLE WITH PART DN150-33 (BLUE)	1
004	DN150-36	GAS TANK CROSS MEMBER BLUE	AVAILABLE WITH PART DN150-33 (BLUE)	2
005	DN150-37	PADDING FRAME SHORT		2
006	DN150-38	BOLT M8-1.25X55, HEX (PT)		2
007	DN150-39	WASHER M8X14X2, SPRING		10
008	DN150-40	WASHER SPHERICAL M8		12
009	DN150-41	BOLT M8-1.25X45, HEX (PT)		6
010	DN150-42	NUT M8-1.25X9, FLANGE SELF LOCK		2
011	DN150-43	BOLT M8-1.25X55, HEX (PT)		2
012	DN150-419	SEAT, DRIVERS		1
012	DN150-44	SEAT, PASSENGER		1
012	DN150-44	SEAT, PASSENGER		1
013	DN150-45	SEAT BELT		2
013	DN150-45	SEAT BELT		2
014	DN150-606	GAS TANK RED		1
014	DN150-46	GAS TANK BLUE		1
014	DN150-46	GAS TANK BLUE		1
015	DN150-47	GAS TANK CAP		1
015	DN150-47	GAS TANK CAP		1
016	DN150-48	BOLT M8-1.25X80, FLANGE (PT)		4
016	DN150-48	BOLT M8-1.25X80, FLANGE (PT)		4
017	DN150-620	COLLAR, TANK COMP (RED)		4
017	DN150-49	COLLAR, TANK COMP (BLUE)		4
017	DN150-49	COLLAR, TANK COMP (BLUE)		4
018	DN150-50	RUBBER MOUNT		4
019	DN150-51	NUT M8-1.25X9, FLANGE SELF LOCK		4
019	DN150-51	NUT M8-1.25X9, FLANGE SELF LOCK		4
020	DN150-52	FUEL VALVE		1
020	DN150-52	FUEL VALVE		1
021	DN150-53	FUEL LINE (TANK TO CARB)		1

021	DN150-53	FUEL LINE (TANK TO CARB)		1
022	DN150-54	TUBE COMP. FUEL. #2 FILTER	FILTER (NOT AVAILABLE)	1
023	DN150-55	TUBE COMP. VACUUM		1

Seatbelt [Image]



Seatbelt

Item No	Part Number	Description	Baja Description	Qty
	DN150-137	NUT M12-1.25X11, HEX		2
	DN150-15	NUT M8-1.25X9, FLANGE SELF LOCK	NUT M8-1.25X9, FLANGE SELF LOCK	5
	DN150-171	BOLT M10-1.25X25, HEX (FT)		1
	DN150-122	WASHER M10X21X2, PLATE		5
	DN150-806	BOLT M12-1.25X30, HEX (PT)		2
	DN150-807	WASHER M12X24X2.50, PLATE		2
	DN150-808	WASHER M12		2
013	DN150-45	SEAT BELT		2

Front Suspension [Image]

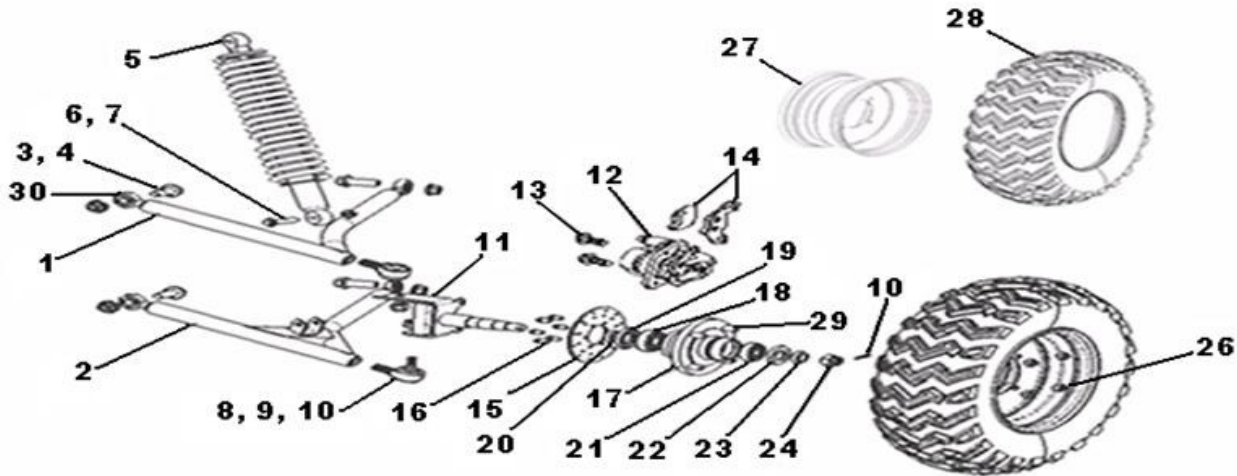

Front Suspension

Item No	Part Number	Description	Baja Description	Qty
	DN150-627	BUMPER FRONT PLASTIC END CAPS		2
	DN150-418	SPHERICAL WASHER	SPHERICAL WASHER GAS TANK BOLT	4
	DN150-137	NUT M12-1.25X11, HEX		2
	DN150-15	NUT M8-1.25X9, FLANGE SELF LOCK	NUT M8-1.25X9, FLANGE SELF LOCK	5
	DN150-171	BOLT M10-1.25X25, HEX (FT)		1
	DN150-122	WASHER M10X21X2, PLATE		5
	DN150-806	BOLT M12-1.25X30, HEX (PT)		2
	DN150-807	WASHER M12X24X2.50, PLATE		2
	DN150-808	WASHER M12		2
	DN150-420	BUSHINGS, FRONT SHOCK, (TOP & BOTTOM)		4
	DN150-422	SHOCK BUSHING, METAL		4
	DN150-813	WASHER M12X20X4, SPRING		4

	DN150-420	BUSHINGS, FRONT SHOCK, (TOP & BOTTOM)		4
	DN150-422	SHOCK BUSHING, METAL		4
	DN150-813	WASHER M12X20X4, SPRING		4
001	DN150-56	A-ARM UPPER		2
002-1	DN150-57	A-ARM LOWER LH		1
002-2	DN150-58	A-ARM LOWER RH		1
003	DN150-59	BOLT M12-1.25X40, FLANGE (PT)		8
004	DN150-60	NUT M12-1.25X12, FLANGE SELF LOCK	AVAILABLE WITH SD65-153	8
005	DN150-61	SHOCK FRONT, YELLOW, CHROME CENTER	CHROME CENTER	2
005	DN150-811	SHOCK FRONT, YELLOW, BLACK CENTER	BLACK CENTER	2
006	DN150-62	BOLT M10-1.25X40, HEX (PT)		2
007	DN150-63	NUT M8-1.25X9, FLANGE SELF LOCK		2
008	DN150S-064	BALL JOINT (26X12MM / 47X14MM)	FOR UNIT WITH DOUBLE DRIVE CHAIN	4
009	DN150-65	NUT M12-1.25X12, CASTLE		4
010	DN150-66	PIN M2X32, COTTER	PIN M2X29, COTTER	6
011-1	DN150-67	SPINDLE FRONT LH		1
011-2	DN150-68	SPINDLE FRONT RH		1
012	DN150-69	BRAKE CALIPER		2
012	DN150-419	SEAT, DRIVERS		1
013	DN150-70	BOLT M8-1.25X15, FLANGE (FT)		4
013	DN150-45	SEAT BELT		2
014	DN150-606	GAS TANK RED		1
014	DN150-71	BRAKE PAD, FRONT		2
015	DN150-72	BRAKE DISK		2
016	DN150-73	BOLT M6-1.0X12, HEX (FT)		12
017	DN150-620	COLLAR, TANK COMP (RED)		4
017	DN150-74	WHEEL HUB		2
018	DN150-75	BEARING		2
019	DN150-76	BEARING SEAL		2
020	DN150-77	BUSHING BRASS		2
021	DN150-78	BEARING		2
022	DN150-79	BEARING SEAL		2
023	DN150-80	BUSHING BRASS		2
024	DN150-81	NUT M14-1.5X15, HEX CASTLE		2
026	DN150-82	NUT M10-1.25X10, FLANGE SELF LOCK	NUT M10-1.25X10, FLANGE SELF LOCK	8
027	DN150-83	RIM, WHEEL	RIM, FRONT WHEEL	2
028	DN150-84	TIRE FRONT 19X7-8		2
029	DN150-383	HUB BOLT		16
030	DN150-384	EYE JOINT (A-ARM)		8

Steering [Image]

-

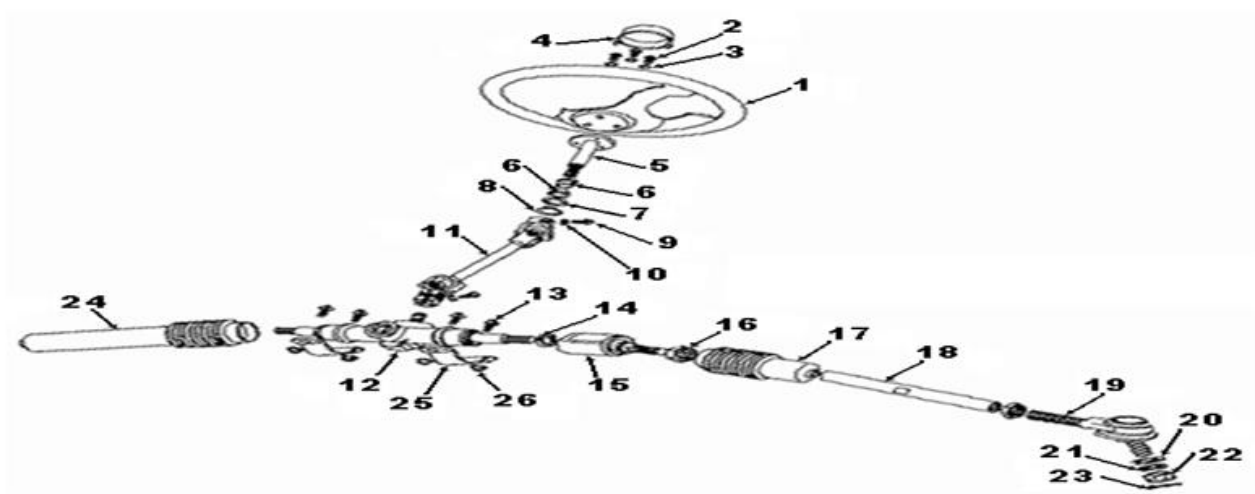

Steering

Item No	Part Number	Description	Baja Description	Qty
	DN150-805	bracket assy. for mounting steering colu		1
001	DN150-85	STEERING WHEEL		1
002	DN150-86	BOLT M6-1.0X12, HEX (FT)		3
003	DN150-87	WASHER LOCK M6		3
004	DN150-88	COVER. STEERING BOLT		1
005	DN150-89	STEERING SHAFT		1
006	DN150-90	BUSH. STEERING SHAFT		2
007	DN150-91	WASHER. SPECIAL M20		1
008	DN150-92	CIRCLIP 20		1
009	DN150-93	BOLT HHCS M8x25		2
010	DN150-94	WASHER M8X14X3, SPRING		2
011	DN150-95	STEERING KNUCKLE (u-joint)		1
012	DN150-96	STEERING GEAR		1
013	DN150-97	BOLT M8-1.25X61, FLANGE (PT)		4
014	DN150-98	ROUND NUT M16x1.5		1
015	DN150-99	STEERING BALL JOINT		2
016	DN150-100	NUT M10		2
017	DN150-101	DUST COVER BALL JOINT		1
018	DN150-102	TIE ROD (28.73 CM)		2
019	BR150S-277	ROD END (24X10MM / 47X12MM)		2
019	DN150-103	ROD END (24X9MM / 37X10MM)		2
020	DN150-104	WASHER M10X16X2, SPRING		2
021	DN150-105	WASHER M10X20X2, PLATE		2
022	DN150-106	NUT M10-1.25X12, CASTLE		2
023	DN150-107	PIN M3X27, COTTER		2
024	DN150-101	DUST COVER BALL JOINT		1
025	DN150-109	BRACKET. STEERING GEAR		1
026	DN150-110	NUT M8-1.25X10, FLANGE SELF LOCK	NUT M8-1.25X10, FLANGE SELF LOCK	4

Rear Axle [Image]

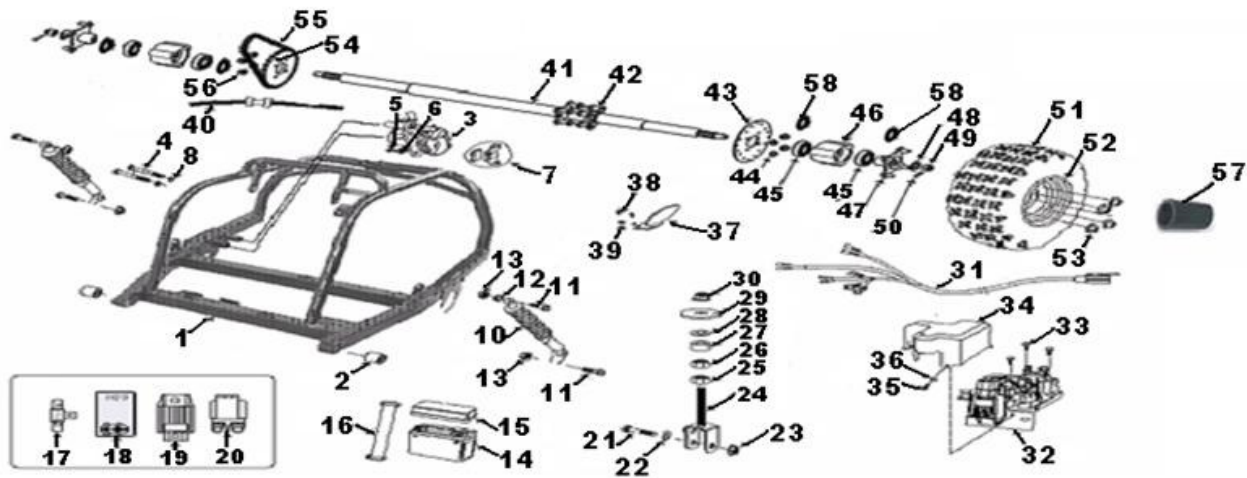

Rear Axle

Item No	Part Number	Description	Baja Description	Qty
	BR150S-550	FUSE HOLDER		1
	DN150-814	WIRING HARNESS WITH RELAY & BATTERY CABL		1
	DN150-108	HEADLIGHT WIRE HARNESS, L.F. BRUSHGUARD	HEADLIGHT WIRE HARNESS, L.F. BRUSHGUARD	1
	DN150-383	HUB BOLT		16
	DN150-128	FUSE 15A / 250V GLASS TUBE		2
001	DN150-111	RR. SWINGARM		1
002	DN150-112	RUBBER BUSH, RR. SWINGARM		2
003	DN150-113	BRAKE CALIPERS		1
004	DN150-114	BOLT M10-1.25X150, FLANGE (PT)		2
005	DN150-115	FLANGE BOLT M10x1.25x40		2
006	DN150-116	NUT M10-1.25X10, FLANGE SELF LOCK		2
007	DN150-117	BRAKE PADS		1
008	DN150-118	WASHER M8X14X3, SPRING		2
010	DN150-120	REAR SHOCK	CHROME CENTER	2
010	DN150-812	REAR SHOCK	BLACK CENTER	2
011	DN150-121	BOLT M10-1.25X45, HEX (PT)		4
012	DN150-122	WASHER M10X21X2, PLATE		5
013	DN150-123	NUT M10-1.25X10, FLANGE SELF LOCK		4
014	50-01-9002	BATTERY (YTX7L-BS-FP)		1
015	DN150-125	BATTERY COVER		1
016	DN150-126	BATTERY STRAP		1
017	DN150-127	RESISTER		1
018	DN150-130	CDI		1
019	DN150-131	RECTIFIER COMP.,REGULATE		1
020	DN150-132	STARTER RELAY		1
021	DN150-133	BOLT M10-1.25X40, HEX (PT)		1
022	DN150-134	WASHER M10X20X2, PLATE		1
023	DN150-135	NUT M10-1.25X10, FLANGE SELF LOCK	NUT M10-1.25X10, FLANGE SELF LOCK	1
024	DN150-136	RR. ENGINE BRACKET		1
025	DN150-137	NUT M12-1.25X11, HEX		2
026	DN150-138	ENGINE MOUNT COLLAR LINK		1
027	DN150-139	ENGINE MOUNT SPACER LINK		1
028	DN150-140	WASHER M8, SPHERICAL		1
029	DN150-141	FLAT WASHER M12		1
030	DN150-142	NUT FLANGE M12X1.25		1
031	DN150-143	WIRING HARNESS, SECONDARY		1
032	DN150-144	ELECTRICAL BOX		1

033	DN150-145	BOLT M5-0.8X15, ROUND (FT)	USED FOR MASTER CYLINDER	1
034	DN150-146	COVER, ELECTRICAL BOX		1
035	DN150-147	WASHER M4X9X1, PLATE		1
036	DN150-148	BOLT M4-0.7X10, ROUND (FT)		1
037	DN150-149	REAR DISC COVER		1
038	DN150-150	FLANGE BOLT M6x16		2
039	DN150-151	WASHER M6X11X2, SPRING		2
040	DN150-152	BRAKE LINE, REAR		1
040	DN150-775	BRAKE LINE T (LINKER ASSEMBLY)	BRAKE LINK (FR BRAKE CABLES)	1
040	DN150-400	BRAKE LINE, LEFT		1
040	DN150-401	BRAKE LINE, RIGHT		1
040	DN150-402	BRAKE LINE, MIDDLE LINK		1
041	DN150-153	AXLE		1
042	DN150-154	BOLT STUD M8X25		8
043	DN150-155	BRAKE DISK		1
044	DN150-156	NUT M8-1.25X9, FLANGE SELF LOCK		8
045	DN150-157	BEARING		4
046	DN150-158	BEARING BASE		2
047	DN150-159	WHEEL HUB		2
048	DN150-160	WASHER M16X38X5, PLATE	WASHER M16X38X5, PLATE	2
049	DN150-161	NUT M16-1.5X16, HEX CASTLE	AVAILABLE WITH SD65-153	2
050	DN150-162	PIN M3.5X43, COTTER		2
051	DN150-163	RR. TIRE 22X11-10		2
052	DN150-164	RR. RIM		2
053	DN150-165	NUT M10-1.25X10, FLANGE SELF LOCK		8
054	DN150-410	SPROCKET, AXLE	SPROCKET, AXLE	1
055	DN150-409	CHAIN, 520 / 27 LINKS		1
056	DN150-156	NUT M8-1.25X9, FLANGE SELF LOCK		8
057	DN150-188	RUBBER DUST COVER FRONT AND REAR		4
058	DN150-129	OIL SEAL 35X56X12	OIL SEAL, BEARING BASE	4

Engine and Muffler [Image]

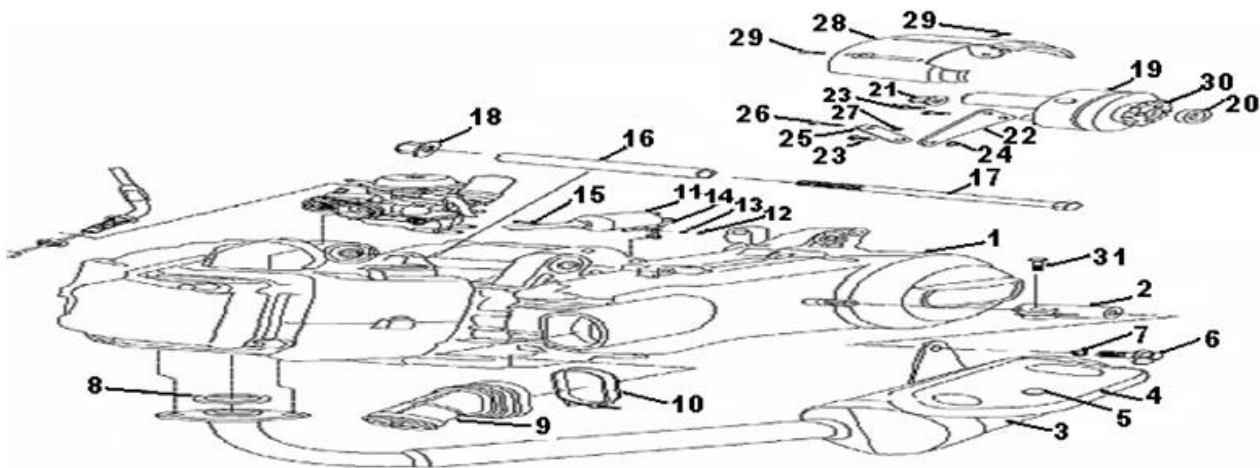

Engine and Muffler

Item No	Part Number	Description	Baja Description	Qty
	DN150-404	CIRCLIP FOR REV. CABLE	REVERSE CABLE, CIRCLIP	1
	DN150-405	Taping Screw For Reverse	REVERSE CONNECTOR, TAP SCREW	2
	DN150-406	Reverse Cable Connector	REVERSE CABLE CONNECTOR	1
	DN150-421	NUT M6-1.0X34.50, CAP		2
001	DN150-166	ENGINE (150CC GO KART)	ENGINE	1
002	DN150-167	RACK SUPPORT MUFFLER	MUFFLER STUD	1

003	DN150-168	MUFFLER	MUFFLER	1
004	DN150-169	PROTECTOR MUFFLER		1
005	DN150-170	BOLT M6-1.0X12, HEX (FT)		1
006	DN150-171	BOLT M10-1.25X25, HEX (FT)		1
007	DN150-172	WASHER M10X30X2.50, PLATE		1
008	DN150-173	GASKET EXHAUST PIPE		1
009	DN150-174	BOOT SIDE CASE		1
010	DN150-175	CLAMP BOOT		1
011	DN150-176	IGNITION COIL		1
012	DN150-177	NUT M6-1.0X7, FLANGE SELF LOCK		1
013	DN150-178	WASHER M6X12X2, PLATE		1
014	DN150-179	BRACKET, IGNITION COIL		1
015	DN150-180	BOLT M6-1.0X25, FLANGE (PT)		1
016	DN150-181	FR. FIXING COLLAR, ENGINE		1
017	DN150-182	FR. HANGED BOLT, ENGINE		1
018	DN150-183	NUT M10-1.25X10, FLANGE SELF LOCK		1
019	DN150-184	REVERSE ASSEMBLY		1
020	DN150-185	INTERNAL COLLAR REVERSE		1
021	DN150-186	NUT M16-1.5X16, FLANGE SELF LOCK		1
022	DN150-187	BRACKET REVERSE		1
023	DN150-219	BOLT STRAP M10 X 1.25 X 20		2
024	DN150-223	NUT FLANGE LOCK M10		1
025	DN150-190	CONNECTOR PANEL REVERSE		1
026	DN150-273	BOLT STRAP M8 X 1.25 X 40		1
027	DN150-192	LOCK NUT, FLANGE M8		1
028	DN150-193	CHAIN PROTECTOR		1
029	DN150-194	BOLT W/WASHER M5-0.8X10, ROUND (FT/S)		2
030	DN150-417	COUNTERSHAFT SPROCKET	DRIVE SPROCKET	1
031	DN150-220	BOLT HHCS		1

Controls [Image]

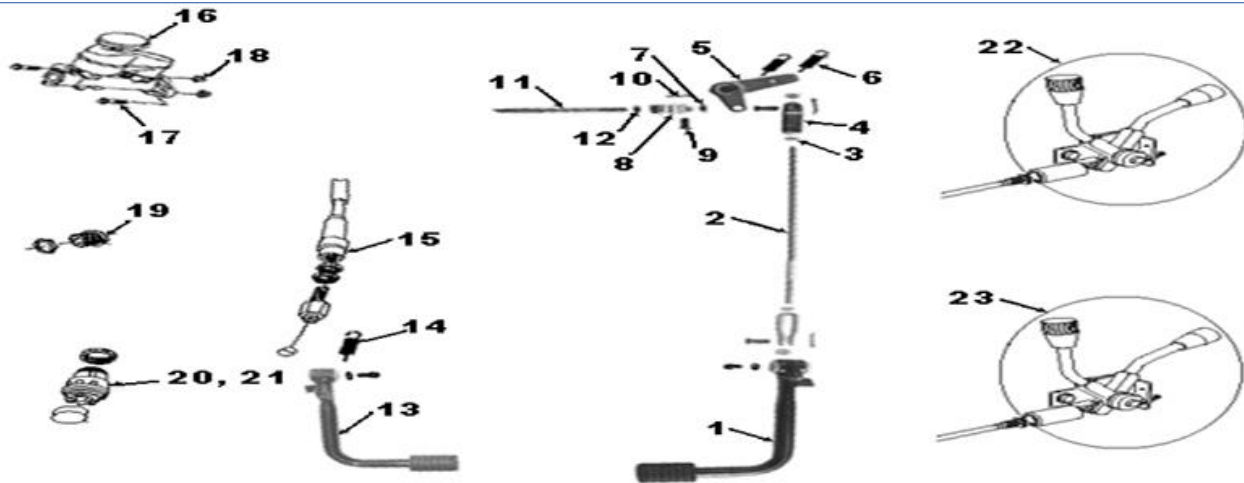

Controls

Item No	Picture	Part Number	Description	Baja Description	Qty
		DN150-815	KEYS (1 SET)	ALL KEYS ARE UNIVERSAL	2
		DN150-224	BOOT, REVERSE LEVER	BOOT, REVERSE LEVER	2
		DN150-450	Cable, Reverse	CABLE, REVERSE	1
		DN150-408	CABLE, PARKING BRAKE	CABLE, PARKING BRAKE	1
	Pic	DN150-411	BRAKE LINK (MASTER CYLINDER)	BRAKE LINK (MASTER CYLINDER)	1
	Pic	DN150-412	BOLT, FLANGE 1.25" (BRAKE CABLE)	BOLT, BANJO	1
	Pic	DN150-413	BOLT M10-1.25X22, FLANGE BANJO (PT)	BOLT, BANJO	8

	Pic	DN150-414	SEAL, FLANGE BOLT (BRAKE CABLE)	SEAL, FLANGE BOLT (BRAKE CABLE)	18
	Pic	DN150-430	BRAKE CYLINDER SWITCH	BRAKE CYLINDER SWITCH	1
		DN150-225	BUSHING, RIGHT AND LEFT PEDAL	BUSHING, RIGHT AND LEFT PEDAL	2
001		DN150-195	BRAKE PEDAL (BLUE)	BRAKE PEDAL (BLUE)	1
001		DN150-607	BRAKE PEDAL RED	BRAKE PEDAL (RED)	1
002		DN150-196	BRAKE ROD		1
003		DN150-197	NUT M6-1.0X7, HEX		2
004		DN150-198	BRAKE GEMEL 6MM	BRAKE CLEVIS	2
005		DN150-199	BRAKE ARM		1
006		DN150-200	BRAKE SPRING		2
007		DN150-201	NUT M8-1.25X5, HEX		1
008		DN150-202	BRAKE GEMEL 8MM		1
009		DN150-203	PIN B 6X16		1
010		DN150-204	PIN SPECIAL2X24	COTTER PIN	1
011		DN150-205	MASTER CYL ROD	MASTER CYLINDER ROD	1
012		DN150-206	NUT M8-1.25X5, HEX		1
013		DN150-207	THROTTLE PEDAL (BLUE)	THROTTLE PEDAL (BLUE)	1
013		DN150-608	THROTTLE PEDAL RED	THROTTLE PEDAL (RED)	1
014		DN150-208	THROTTLE SPRING		1
015		DN150-209	THROTTLE CABLE		1
016		DN150-210	MASTER CYLINDER		1
017		DN150-211	BOLT STUD M8X30		1
018		DN150-212	NUT FLANGE M8		1
019		DN150-213	ENGINE STOP SWITCH		1
020		DN150-214	IGNITION SWITCH		1
020		BR150S-103	IGNITION START SWITCH	NO KEYS	1
022		DN150-216	PARKING BRAKE SA	PARKING BRAKE HANDLE ASSYM	1
023		DN150-217	REVERSE LEVER SA	REVERSE BRAKE HANDLE ASSYM	1

Warning Decals [Image]

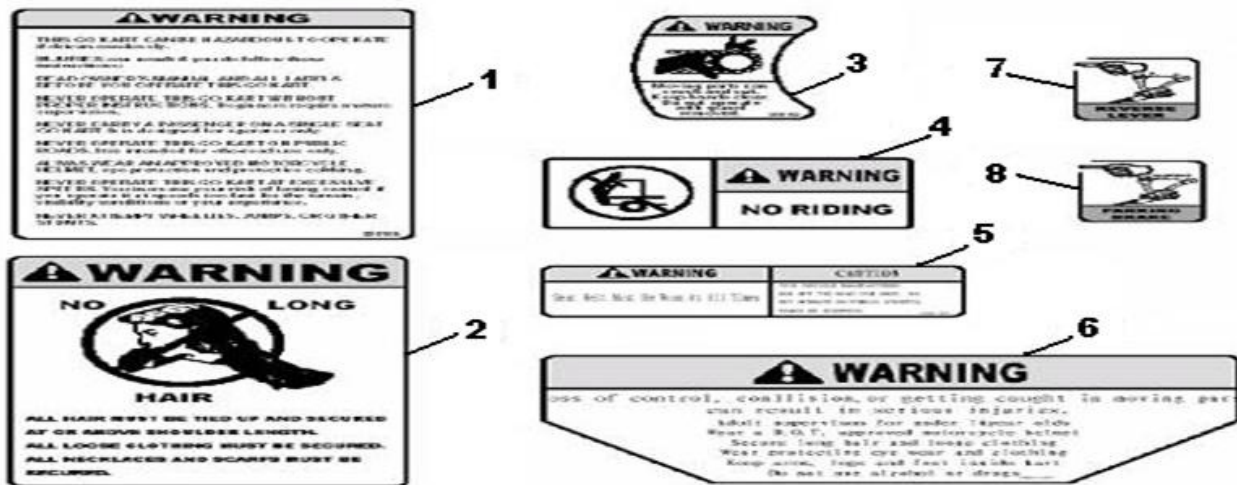

Warning Decals

Item No	Part Number	Description	Baja Description	Qty
001	DN150-218	WANING DECALS - PACKAGE OF 8	WARNING DECALS - PACKAGE OF 8	1

Cylinder Head Cover [Image]

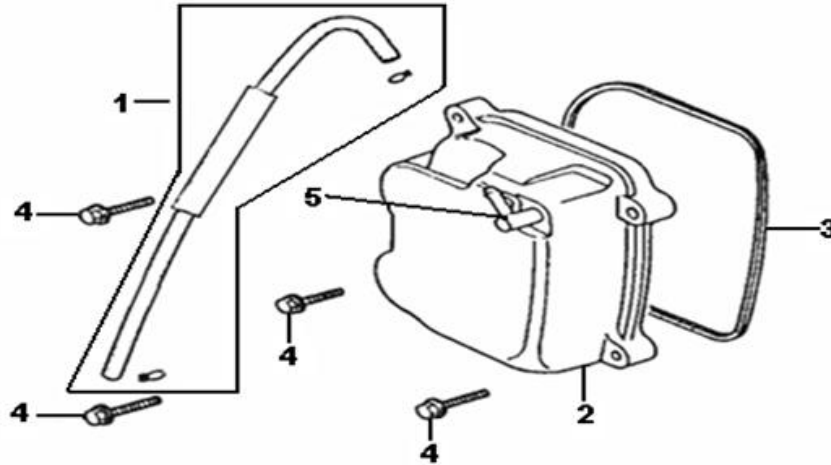

Cylinder Head Cover

Item No	Part Number	Description	Baja Description	Qty
001	DN150-226	TUBE BREATHER		1
002	DN150-227	CYLINDER HEAD COVER		1
003	DN150-228	GASKET, HEAD COVER		1
004	DN150-229	BOLT M6-1.0X24, FLANGE (FT)		4

Camshaft [Image]



Camshaft

Item No	Part Number	Description	Baja Description	Qty
001	DN150-230	CAMSHAFT		1

Camshaft Holder [Image]

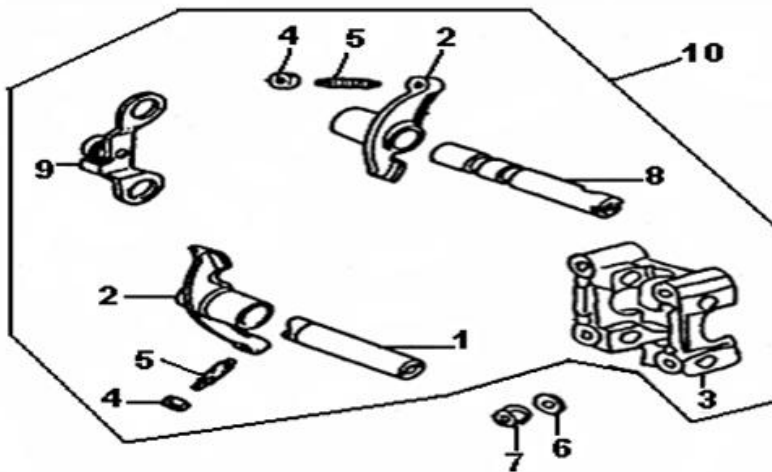

Camshaft Holder

Item No	Part Number	Description	Baja Description	Qty
001	DN150-231	SHAFT EX ROCKER ARM		1
002	DN150-232	ARM VALVE ROCKER		2
003	DN150-233	HOLDER CAMSHAFT		1
004	DN150-234	NUT TAPPET ADJUSTING		2
005	DN150-235	SCREW TAPPET ADJUSTING		2
006	DN150-236	WASHER M8X19X2, PLATE	WASHER M8X19X2, PLATE	4
007	DN150-237	NUT M8-1.25X8, FLANGE		4
008	DN150-238	SHAFT COMP IN ROCKER ARM		1
009	DN150-239	PLATE COMP STOPPER		1
010	DN150-240	HOLDER CAMSHAFT ASSY		1

Cylinder Head [Image]

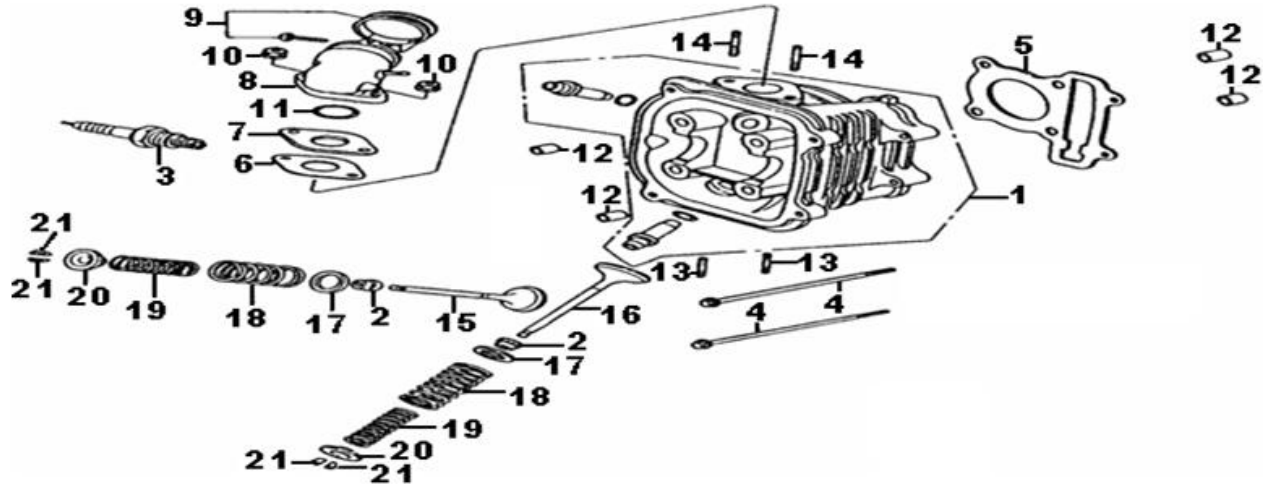

Cylinder Head

Item No	Part Number	Description	Baja Description	Qty
001	DN150-241	HEAD COMP CYLINDER		1
002	DN150-242	SEAL VALVE STEM		2
003	DN150-243	PLUG SPARK		1
004	DN150-244	BOLT M6-1.0X100, FLANGE (PT)		2
005	DN150-245	GASKET CYLINDER HEAD		1
006	DN150-246	GASKET CARBURETOR INSULATOR		1
007	DN150-247	INSULATOR CARBURETOR		1
008	DN150-248	PIPE COMP IN		1
010	DN150-250	NUT M6-1.0X6, FLANGE SPRING LOCK		2
011	DN150-251	O-RING 28.5X1.8		1
012	DN150-252	PIN DOWEL 10X16		4
013	DN150-253	STUD BOLT M6-1.0X32		2
014	DN150-254	STUD BOLT M6-1.0X63		2
015	DN150-255	VALVE EX		1
016	DN150-256	VALVE IN		1
017	DN150-257	SEAT VALVE SPRING OUTER		2
018	DN150-258	SPRING VALVE OUTER		2
019	DN150-259	SPRING VALVE INNER		2
020	DN150-260	RETAINER VALVE SPRING		2
021	DN150-261	COTTER VALVE		4

Carburetor [Image]

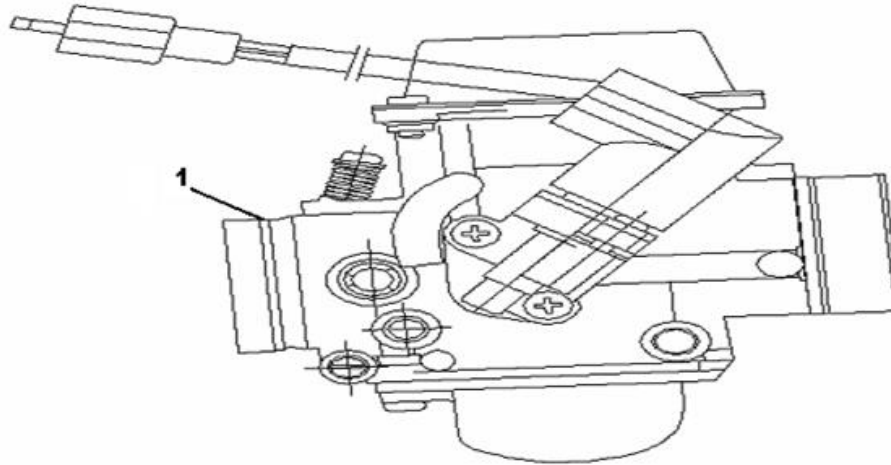

Carburetor

Item No	Part Number	Description	Baja Description	Qty
001	DN150-262	CARBURETOR ASSY		1

Air Cleaner [Image]

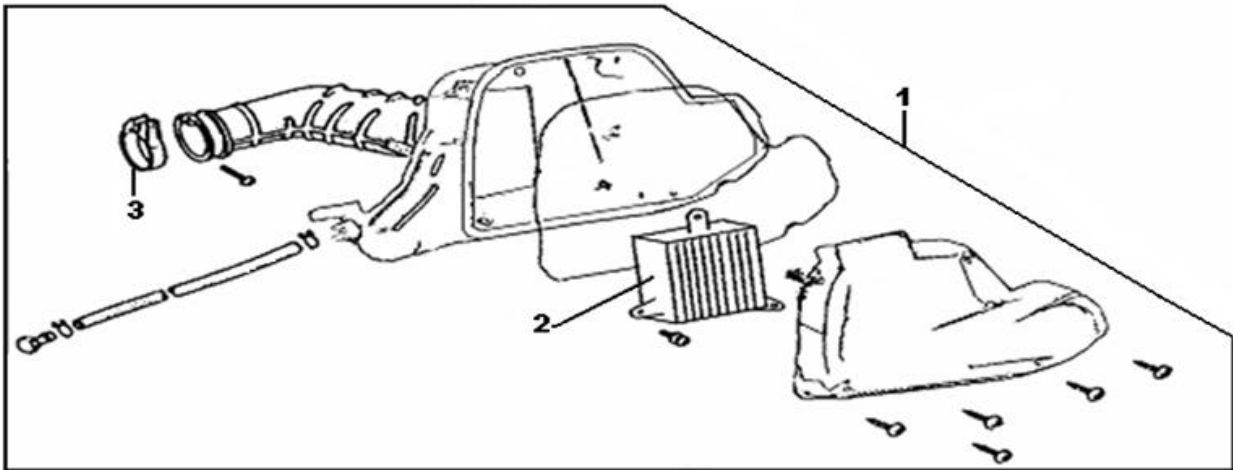

Air Cleaner

Item No	Part Number	Description	Baja Description	Qty
001	DN150-263	AIR CLEANER		1
001	DN150-816	AIR CLEANER ORIGINAL		1
002	DN150-264	ELEMENT COMP AIR CLEANER		1
003	DN150-191	CLAMP		1

Left Crankcase Cover [Image]

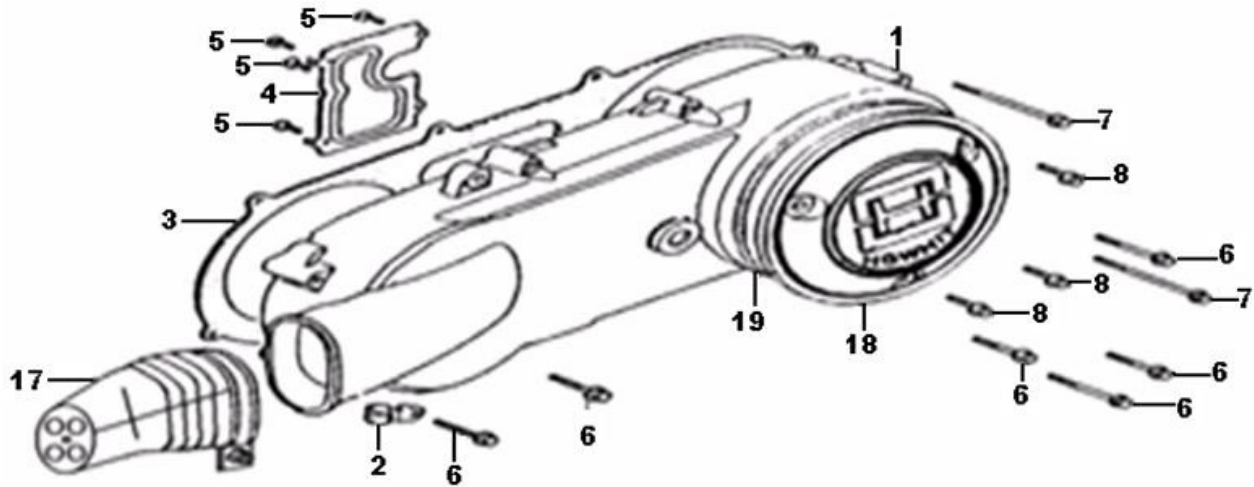

Left Crankcase Cover

Item No	Part Number	Description	Baja Description	Qty
001	DN150-265	COVER LEFT		1
002	DN150-266	CLAMPER BREATHER DRAIN TUBE		1
003	DN150-267	GASKET LEFT COVER		1
004	DN150-268	PLATE LEFT COVER		1
005	DN150-269	SCREW TAPPING 4X6		4
006	DN150-270	BOLT FLANGE 6X40		6
007	DN150-271	BOLT FLANGE 6X65		2
008	DN150-272	BOLT M6-1.0X16, FLANGE (FT)		3
017	DN150-174	BOOT SIDE CASE		1
018	DN150-274	BRAND COVER		1
019	DN150-275	GASKET BRAND COVER		1

Clutch [Image]

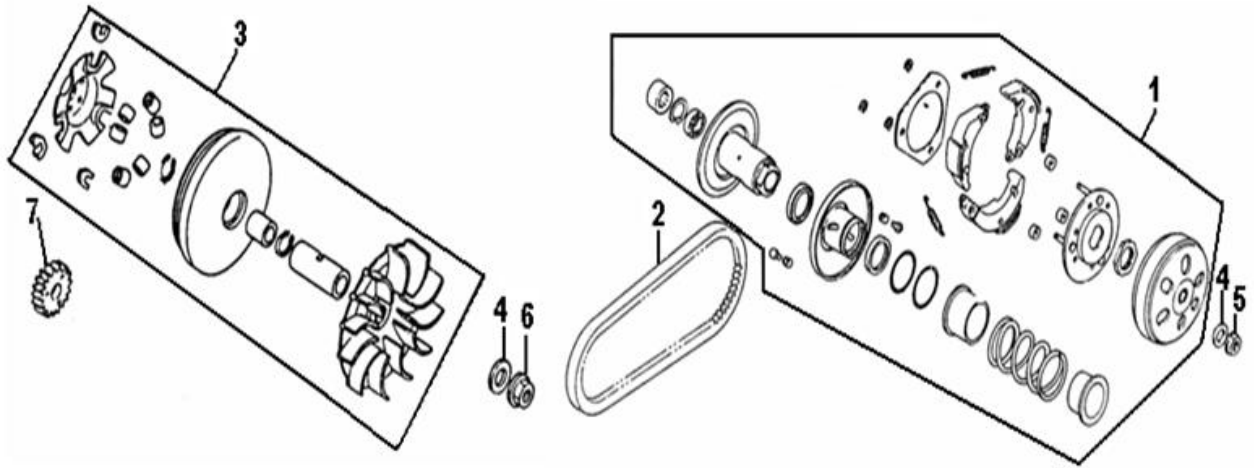

Clutch

Item No	Part Number	Description	Baja Description	Qty
001	DN150-276	PULLEY ASSY DRIVEN		1
002	BR150S-472	BELT DRIVE 743	FOR UNITS WITH DOUBLE DRIVE CHAIN	1
002	DN150-277	BELT DRIVE 842	FOR UNITS WITH SINGLE DRIVE CHAIN	1
003	DN150-278	PULLEY ASSY.MOVEABLE DRIVEN		1
004	DN150-279	WASHER M12X20X1, PLATE		2
005	DN150-280	NUT M12-1.25X8, FLANGE		1
006	DN150-281	NUT M12-1.25X10, FLANGE		1

007 DN150-282 GEAR KICK 1

Cylinder [Image]

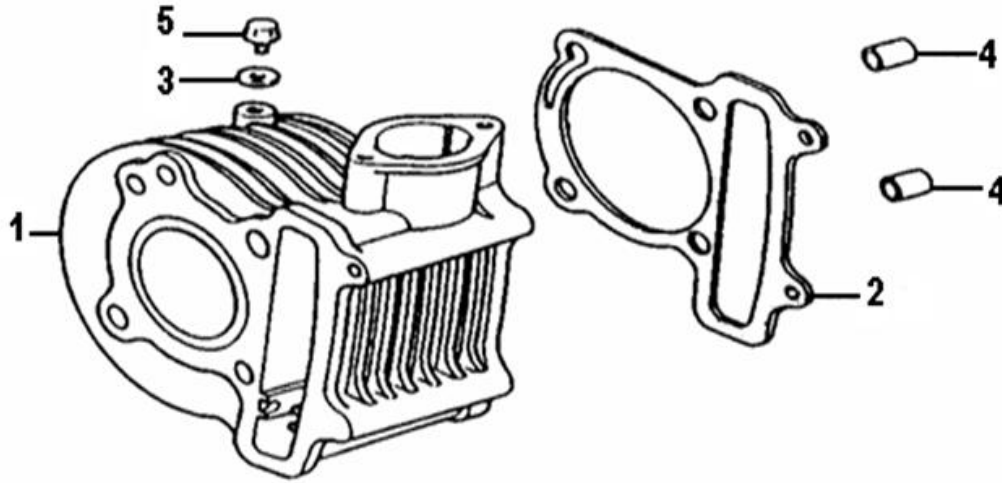

Cylinder

Item No	Part Number	Description	Baja Description	Qty
001	DN150-283	CYLINDER COMP		1
002	DN150-284	GASKET CYLINDER		1
003	DN150-285	WASHER M6X12X1, COPPER PLATE		1
004	DN150-286	PIN DOWEL 10X16		2
005	DN150-287	BOLT M6-1.0X12, FLANGE (FT)		1

Crankshaft [Image]

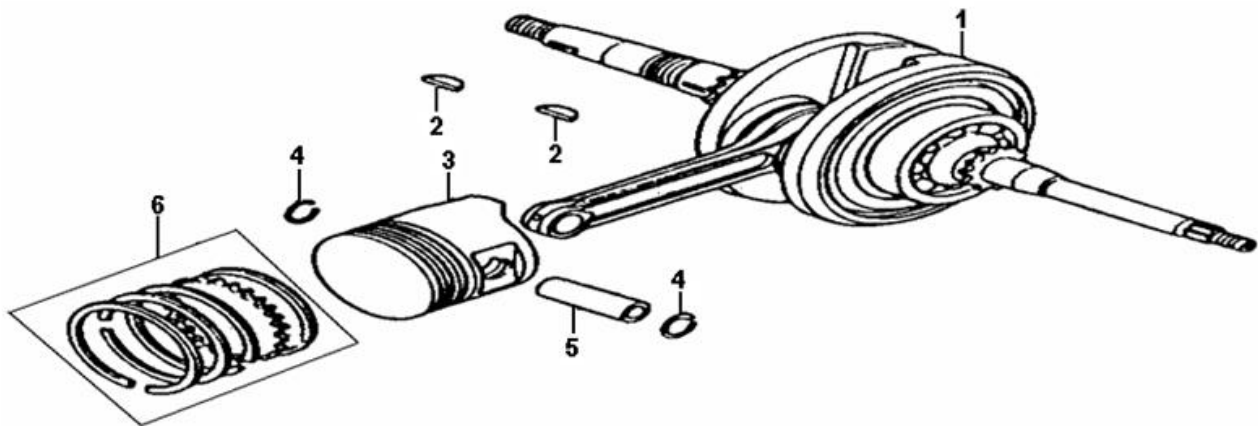

Crankshaft

Item No	Part Number	Description	Baja Description	Qty
001	DN150-288	CRANK SHAFT COMP		1
002	DN150-289	KEY WOODRUFF		2
003	DN150-290	PISTON		1
004	DN150-291	CLIP PISTON PIN 15MM		2
005	DN150-292	PIN PISTON		1
006	DN150-293	PISTON RING		1

Fan Shroud [Image]

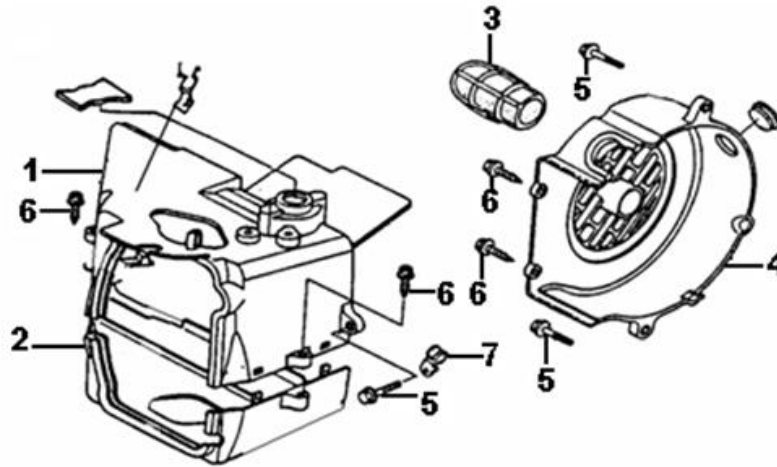

Fan Shroud

Item No	Part Number	Description	Baja Description	Qty
001	DN150-294	UP SHROUD COMP		1
002	DN150-295	DOWN SHROUD COMP		1
003	DN150-296	DUCT CARBURETOR COOLING		1
004	DN150-297	COVER COMP FAN		1
005	DN150-298	BOLT M6-1.0X25, FLANGE (PT)		3
006	DN150-299	SCREW M5X15, HEX		4
007	DN150-300	CLAMPER CARB DRAIN TUBE		1

Magneto [Image]

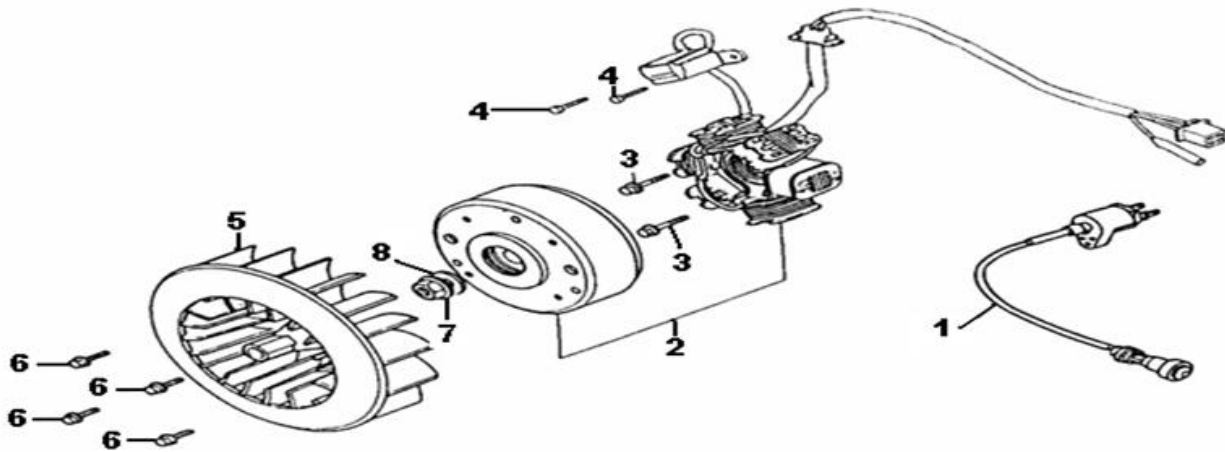

Magneto

Item No	Part Number	Description	Baja Description	Qty
001	DN150-176	IGITION COIL		1
002	DN150-302	GENERATOR ASSY FLYWHEEL TYPE A.C		1
003	DN150-303	BOLT M6-1.0X20, FLANGE (FT)		2
004	DN150-304	BOLT M5-0.8X12, HEX (FT)		2
005	DN150-305	PAN COMP COOLING		1
006	DN150-306	BOLT FLANGE 6X18		4
007	DN150-307	NUT FLANGE 12X1.25		1
008	DN150-308	WASHER PLAIN 12MM		1

Starter Motor [Image]

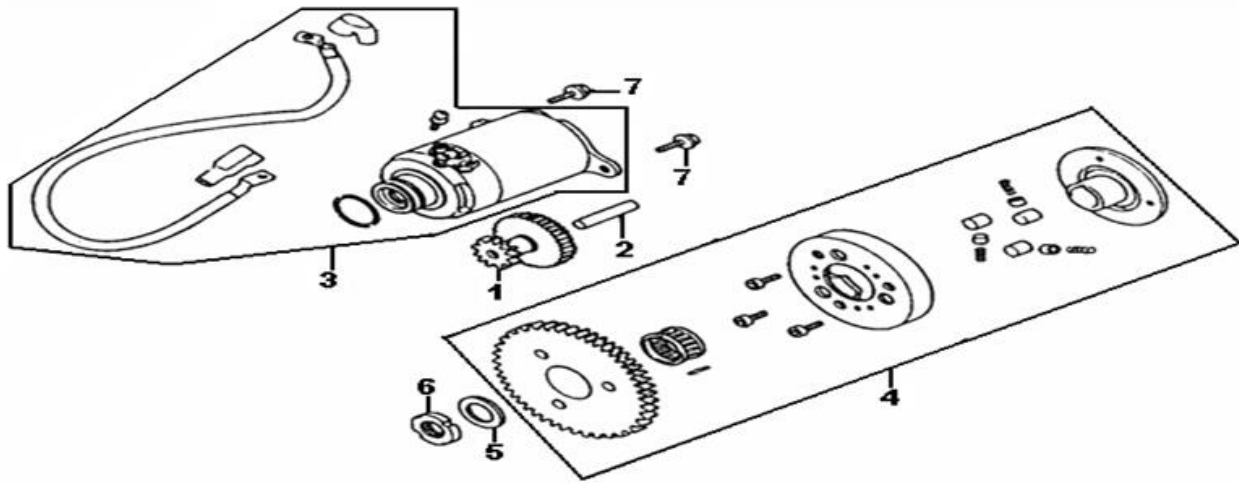

Starter Motor

Item No	Part Number	Description	Baja Description	Qty
001	DN150-309	GEAR STARTER REDUCTION		1
002	DN150-310	SHAFT STARTER REDUCTION GEAR		1
003	DN150-311	MOTOR ASSY STARTER		1
004	DN150-312	STARTER CLUTCH		1
005	DN150-313	WASHER M22X31X2, PLATE		1
006	DN150-314	NUT LOCK		1
007	DN150-315	BOLT M6-1.0X16, FLANGE (FT)		2

Right Crankcase Cover [Image]

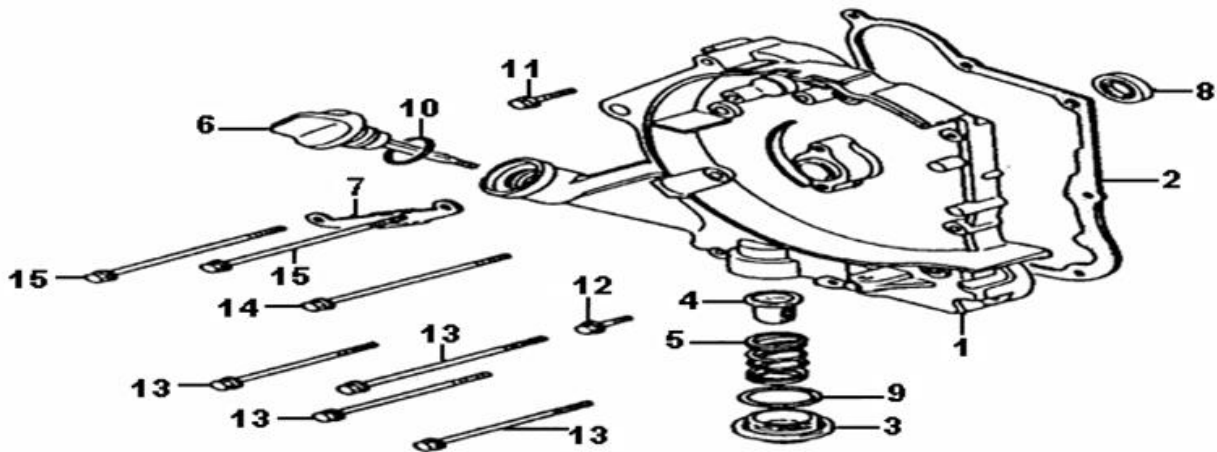

Right Crankcase Cover

Item No	Part Number	Description	Baja Description	Qty
001	DN150-316	RIGHT CRANK CASE COVER		1
002	DN150-317	GASKET R CRANKCASE COVER		1
003	DN150-318	CAP TAPPET ADJUSTING HOLE		1
004	DN150-319	SCREEN OIL FILTER		1
005	DN150-320	SPRING OIL FILTER SCREEN		1
006	DN150-321	GAUGE OIL LEVEL		1
007	DN150-322	CLAMPER A.C. GENERATOR CORD		1
008	DN150-323	OIL SEAL 19.8X30X5		1
009	DN150-324	O-RING 18X3		1
010	DN150-325	O-RING		1
011	DN150-326	BOLT FLANGE 6X35		1
012	DN150-327	BOLT FLANGE 6X32		1

013	DN150-328	BOLT M6-1.0X95, FLANGE (PT)	4
014	DN150-329	BOLT M6-1.0X110, FLANGE (PT)	2
015	DN150-330	BOLT M6-1.0X100, FLANGE (PT)	1

Crankcase [Image]

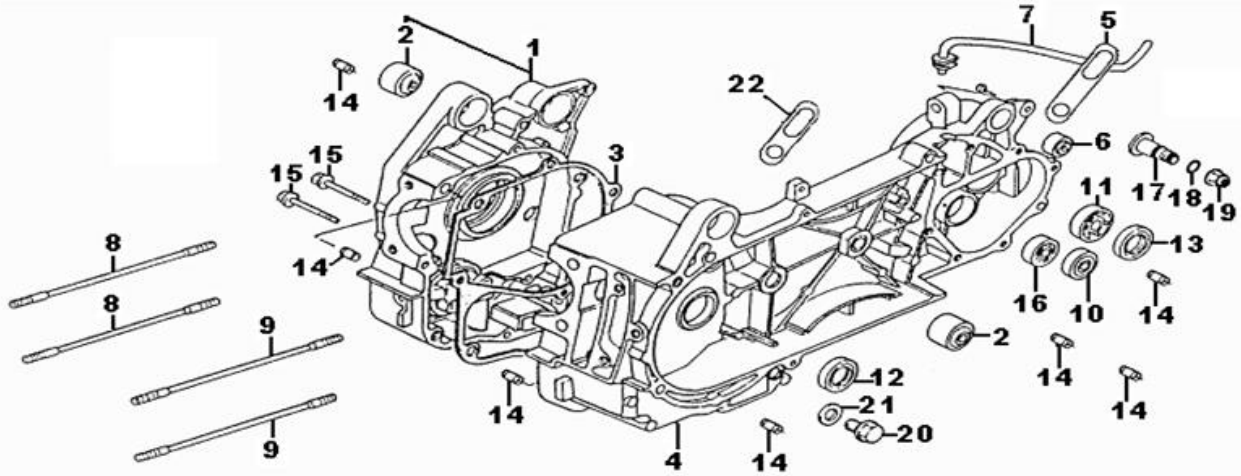

Crankcase

Item No	Part Number	Description	Baja Description	Qty
001	DN150-331	CRANKCASE ASSY RIGHT		1
002	DN150-332	BUSH ENGINE HANGER RUBBER		1
003	DN150-333	GASKET CRANKCASE		1
004	DN150-334	CRANKCASE ASSY LEFT		1
005	DN150-335	AIR CLEANER CONNECT FRONT		1
006	DN150-336	BUSH RR CUSHION UNDER RUBBER		1
007	DN150-337	TUBE BREATHER		1
008	DN150-338	STUD BOLT M8-1.25X187		2
009	DN150-339	STUD BOLT M8-1.25X195		2
010	DN150-340	BEARING RADIAL BALL 102		1
011	DN150-341	BEARING RADIAL BALL 180104		1
012	DN150-342	OIL SEAL 19.8X30X5		1
013	DN150-343	OIL SEAL 27X42X7		1
014	DN150-344	PIN DOWEL 8X14		8
015	DN150-345	BOLT FLANGE 6X50		2
016	DN150-346	BEARING RADIAL BALL 301		1
017	DN150-347	PIN BRAKE SHOE ANCHOR		1
018	DN150-348	O-RING 7.5X1.5		1
019	DN150-349	NUT M8-1.25X9, FLANGE SELF LOCK		1
020	DN150-350	BOLT DRAIN PLUG 12MM		1
021	DN150-351	WASHER DRAIN PLUG 12MM		1
022	DN150-352	AIR CLEANER CONNECT REAR		1

Transmission [Image]

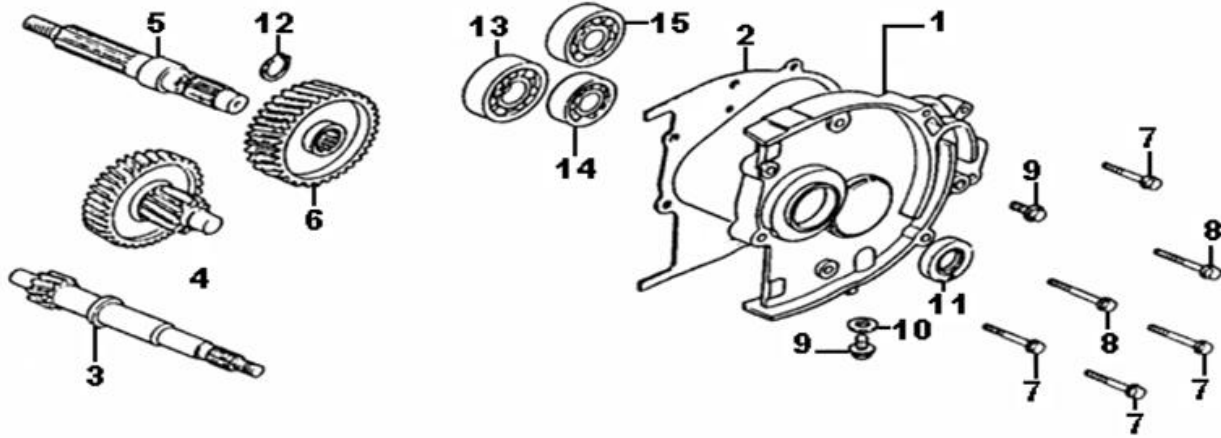

Transmission

Item No	Part Number	Description	Baja Description	Qty
001	DN150-353	COVER MISSION ASSY		1
002	DN150-354	GASKET MISSION COVER		1
003	DN150-355	SHAFT DRIVE		1
004	DN150-356	SHAFT COMP COUNTER		1
005	DN150-357	SHAFT FINAL		1
006	DN150-358	GEAR FINAL		1
007	DN150-359	BOLT M6-1.0X35, FLANGE (PT)		3
008	DN150-360	BOLT M6-1.0X25, FLANGE (PT)		3
009	DN150-361	BOLT M8-1.25X15, FLANGE (FT)		2
010	DN150-362	WASHER M8X16X2, PLATE		2
011	DN150-363	OIL SEAL 20X32X16		1
012	DN150-364	CIR CLIP EXTERNAL 20MM		1
013	DN150-365	BEARING RADIAL 204		1
014	DN150-366	BEARUING RADIAL 202		1
015	DN150-367	BEARUING RADIAL 203		1

Oil Pump [Image]

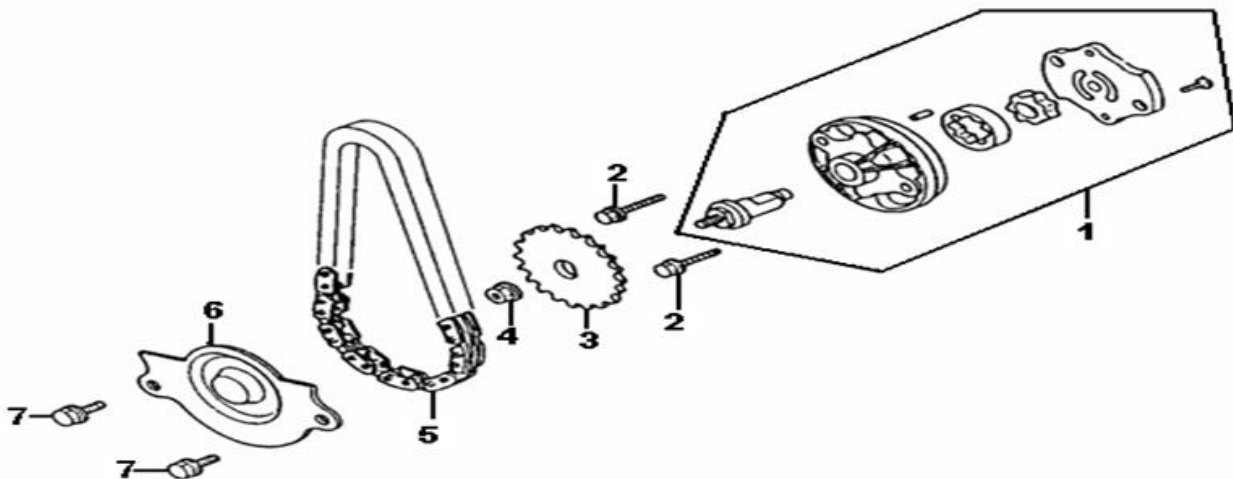

Oil Pump

Item No	Part Number	Description	Baja Description	Qty
001	DN150-368	OIL PUMP COMP		1
002	DN150-369	BOLT M6-1.0X25, FLANGE (PT)		2
003	DN150-370	SPROCKET OIL PUMP DRIVEN		1
004	DN150-371	NUT M6-1.0X6, FLANGE SPRING LOCK		1

005	DN150-372	CHAIN OIL PUMP	1
006	DN150-373	SEPARTOR OIL	1
007	DN150-374	BOLT FLANGE 6X12	2

Timing Chain [Image]

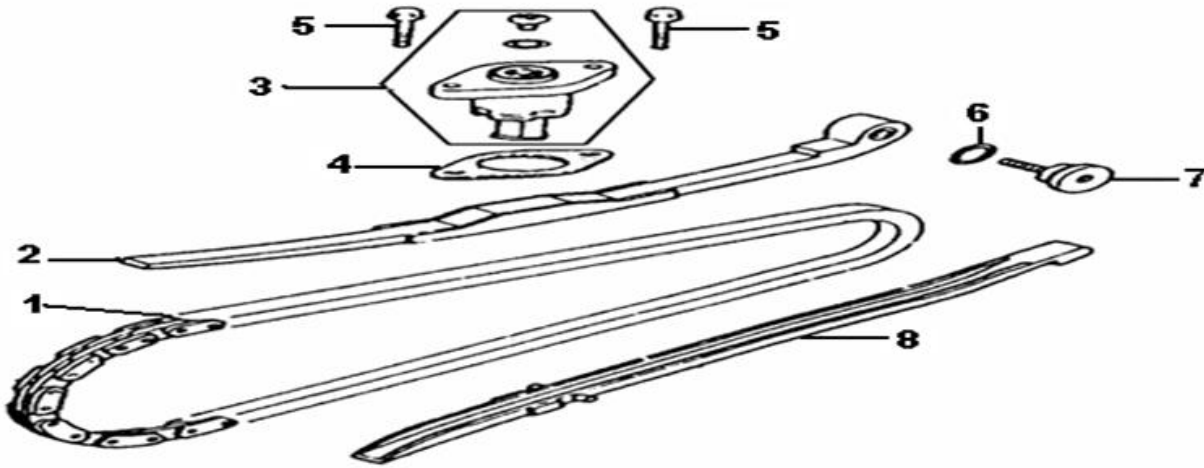

Timing Chain

Item No	Part Number	Description	Baja Description	Qty
001	DN150-375	CHAIN CAM		1
002	DN150-376	TENSIONER CAM CHAIN COMP		1
003	DN150-377	LIFTER ASSY TENSIONER		1
004	DN150-378	GASKET TENSIONER LIFTER		1
005	DN150-379	BOLT FLANGE 6X22		2
006	DN150-380	O-RING 15.2X1.5		1
007	DN150-381	PIVOT CAM CHAIN TENSIONER		1
008	DN150-382	GUIDE COMP CAM CHAIN		1